

BONE DENSITY PATIENT INFORMATION SHEET

Where do I go?

- **THE BONE DENSITY CLINIC, Level 1, Link Wing, The Queen Elizabeth Hospital, 28 Woodville Road, Woodville South.**
- Public car parking is available in the multi-storey undercover carpark located in front of the Emergency Department; the cost is \$3 per hour
- Please allow yourself plenty of additional time for the 300m walk from the multistorey carpark to the Bone Density Clinic.
- If you are mobility impaired- a friend/family member is welcome to borrow a wheelchair from the patient enquiries desk to help you get from the carpark to the clinic and back. There is also vehicle 'drop-off only' access near the main entrance (behind the café) and the rear entrance of the hospital (physiotherapy department entrance).
- Go to the First Floor and follow the signs to Bone Density.
- Please have a seat in the "Waiting Room" until the operator calls you.
- There is no Receptionist at the Bone Density Clinic.

What should I wear?

We prefer you to wear comfortable clothing without metal parts if possible.

How long does it take?

The whole procedure should be completed in 20 minutes.

Cost to patient?

FREE – There is no fee payable for this service under any circumstances.

What to bring?

If you have a copy of your referral, please bring along to your appointment.

Bring your Medicare Card or Veterans Affairs Gold Card with you.

What is a bone density scan for?

A bone density test determines if you have osteoporosis — a disorder characterized by bones that are more fragile and more likely to break.

The test uses X-rays to measure how many grams of calcium and other bone minerals are packed into a segment of bone. The bones that are scanned are the lower spine and upper femur.

Why is it done?

Doctors use bone density testing to:

- Determine your risk of broken bones (fractures)
- Confirm a diagnosis of osteoporosis
- Monitor response to osteoporosis treatment

The higher your bone mineral content, the denser your bones are. And the denser your bones, the stronger they generally are and the less likely they are to break.

Please note: Pregnant women will not be scanned unless prior authorisation is obtained.

If you have any further questions, please feel free to ask at your appointment



Government
of South Australia

Health

Central Adelaide
Local Health Network

The Queen Elizabeth Hospital

For more information

For technical interpretation, phone 08 8222 6393 (X-ray room)

For a copy of results, phone 08 8222 6913 (Admin)

Bone Density
T: 08 8222 6913 Fax: 08 8222 6021
E: Health.FaxEndocrineUnitQEH@sa.gov.au

Level 1, Link Wing
28 Woodville Road
Woodville South SA 5011



www.ausgoal.gov.au/creative-commons

© Central Adelaide Local Health Network. All rights reserved

Directions/map

Directions to Bone Density The Endocrine Unit

Go to the main entrance on the ground floor (near Lizzies café), take the lifts to the first floor, when exiting the lifts follow the signs for Bone Density, you will see DOSA on your right, bear left and follow the long corridor to the end, turn right. The waiting room will be in front of you – please take a seat and a member of staff will be with you shortly.

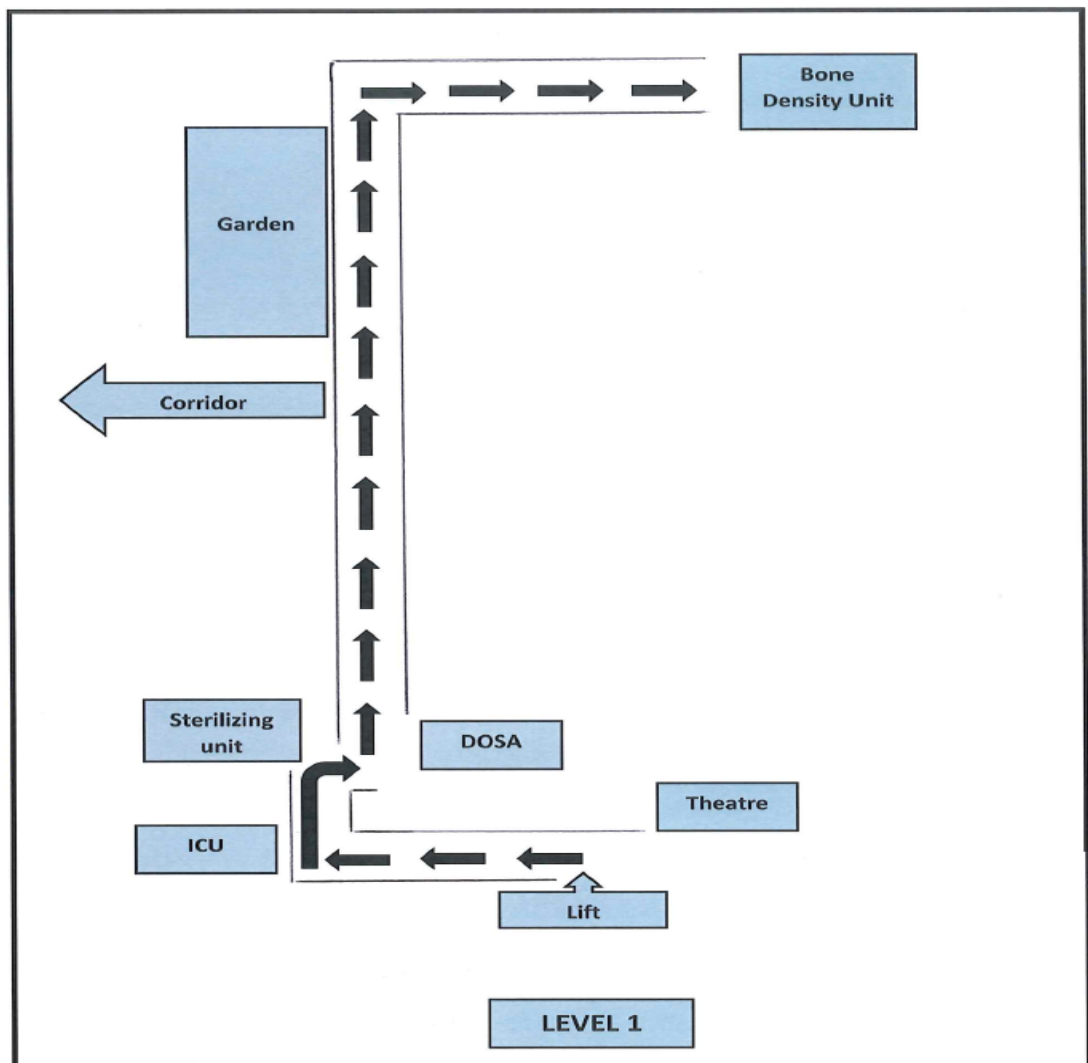

Government
of South Australia

Health

Central Adelaide
Local Health Network